

---

STATUTORY INSTRUMENTS

---

**2011 No. 247**

**HIGHWAYS, ENGLAND**

**The Cobham Motorway Service Area Trunk Road Order 2011**

*Made* - - - - - *8th February 2011*

*Coming into force* - - - - - *23rd February 2011*

The Secretary of State for Transport makes this Order in exercise of powers conferred by section 10 of the Highways Act 1980<sup>(1)</sup> and now vested in him<sup>(2)</sup> and<sup>(3)</sup>:

1.—(1) This Order may be cited as the Cobham Motorway Service Area Trunk Road Order 2011 and shall come into force on 23rd February 2011.

(2) In this Order, all measurements of distance are measured along the route of the relevant highway.

2. The new highway, in relation to which the Secretary of State proposes to enter into an agreement under section 38(3A), along the route described in the Schedule to this Order shall become a trunk road from the date when this Order comes into force.

3. The centre line of the new trunk road is indicated by a heavy black line on the plan numbered HA 10/MP/110 marked “The Cobham Motorway Service Area Trunk Road Order 2011”, signed by authority of the Secretary of State for Transport and deposited at Document Deposit Service, Communities and Local Government, Floor 13 (IMD), Ashdown House, St Leonards on Sea, Hastings, East Sussex TN37 7GA.

Signed by authority of the Secretary of State for Transport

8th February 2011

*Peter Adams*  
A Divisional Director  
Highways Agency

---

(1) 1980 c 66  
(2) SI 1981/238  
(3) SI 2002/2626

---

**Status:** This is the original version (as it was originally made). UK  
Statutory Instruments are not carried in their revised form on this site.

---

## THE SCHEDULE

### ROUTE OF THE NEW TRUNK ROAD

The route of the new trunk road is about 900 metres in length, from Bookham Road Underbridge at M25 marker post 68/6 proceeding westwards to Horsley Road Overbridge at M25 marker post 69/5 all within the County of Surrey.

THE COBHAM MOTORWAY SERVICE AREA  
TRUNK ROAD  
ORDER 2011

KEY:

CENTRE LINE OF THE TRUNK ROAD



SCALES:	SITE PLAN (1 No.)	1:2500
---------	-------------------	--------

PLANS REGISTRY	SIGNED BY AUTHORITY OF THE SECRETARY OF STATE FOR TRANSPORT ON THE 8th February 2011
FILE No. HA 10/MP/110	<i>Peter Adams</i> Divisional Director Major Projects Division Highways Agency

**Status:** This is the original version (as it was originally made). UK Statutory Instruments are not carried in their revised form on this site.

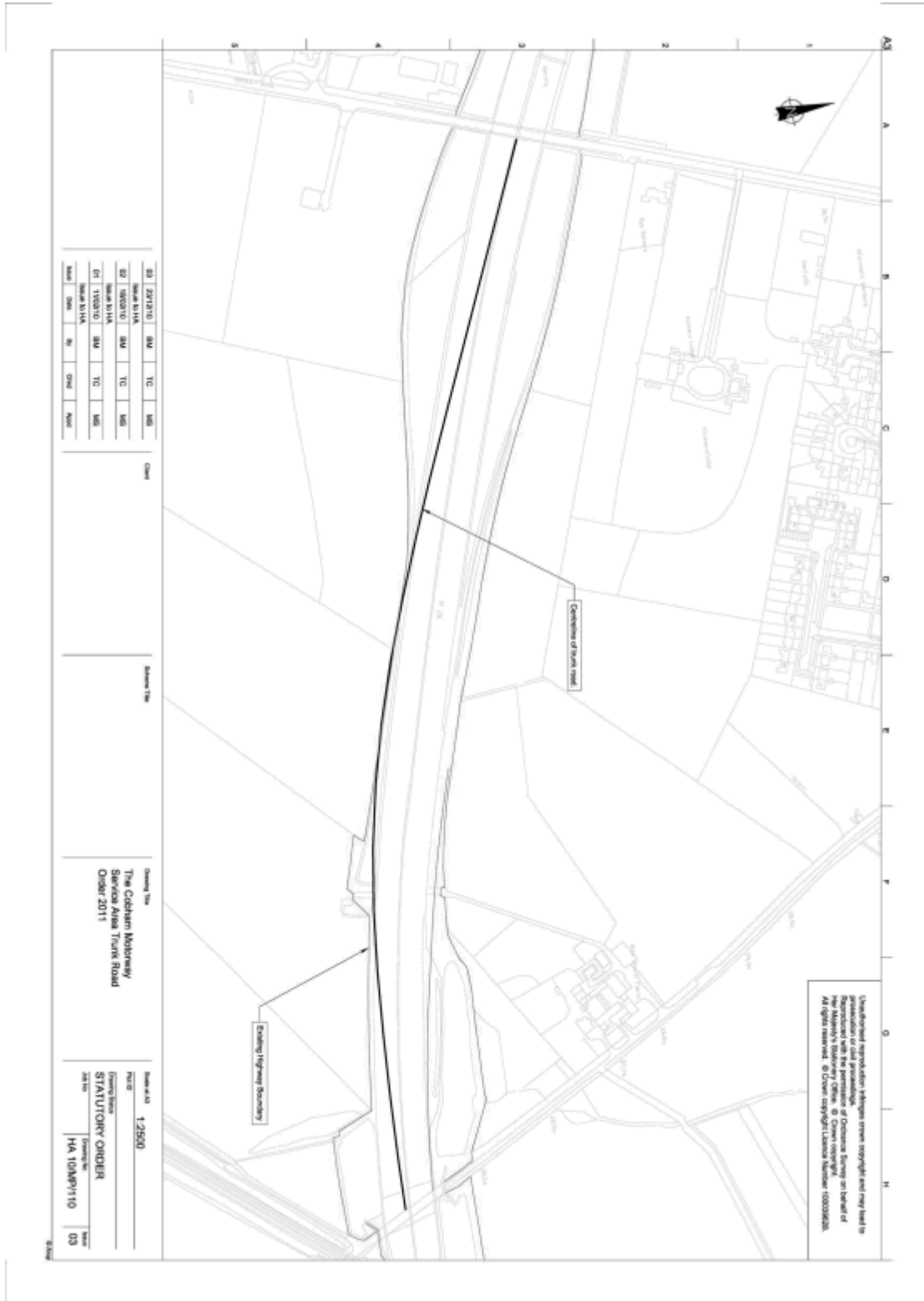

---

### **EXPLANATORY NOTE**

This Order enables the temporary carriageway, to be constructed to the south of the M25 Motorway, at Downside near Cobham in Surrey, to be designated as a motorway for the duration of the works.